

WASTE-TO-ENERGY PLANT

County Meath, Ireland

Located some 40 kilometres north of Dublin, Ireland's first waste-to-energy plant began delivering electricity to the city's grid in November 2011. Babcock & Wilcox Vølund provided the boiler, the combustion grate, the combustion control, as well as an SNCR system.

The combustion system is based on our newest and most efficient grate technology; DynaGrate®. The Belgian company Indaver served as the turnkey supplier in the project and operator of the plant.



Meath is the first waste-to-energy plant in Ireland. 20,000 households in the county will now be provided with waste-powered electricity.



County Meath, Ireland

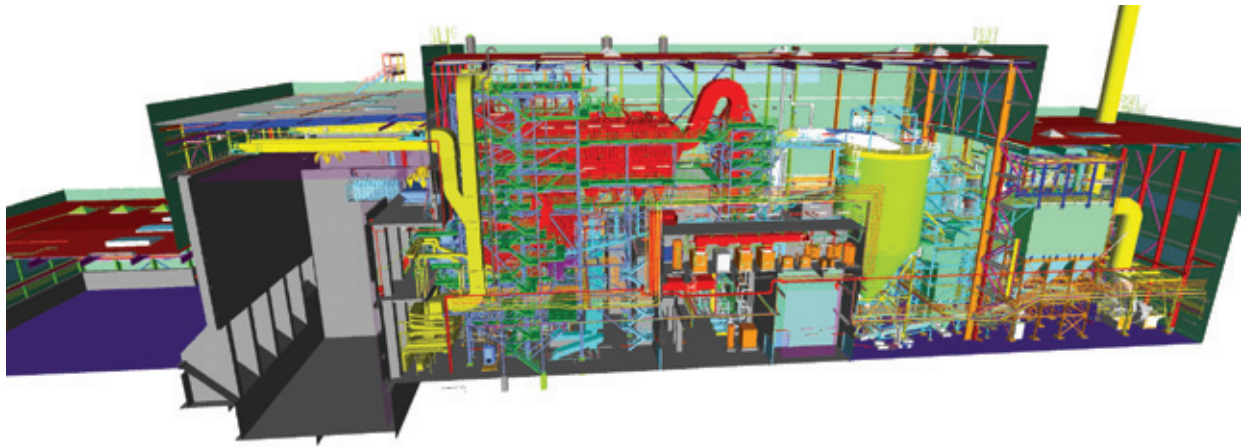

Project Approach

The Meath plant was delivered on schedule as a result of our project methodology and the excellent partnership with our customer Indaver. Babcock & Wilcox Vølund's proven project execution is a result of strong project management skills and close project team cooperation with our client and subcontractors. BWV project managers are certified with the International Project Management Association (IPMA).

In order to make optimal decisions concerning technical solutions we focus on proper communication skills and project management tools. Our project teams are close units of experienced people who cover all aspects of the project with their combined knowledge and skills.

Health and Safety

In Ireland, safety is a top priority. Babcock & Wilcox Vølund won the Safety Award for Contractor of the Month several times during the project, and the project was successfully completed without any accidents. One of the reasons are that we implemented the concept of Human Performance Improvement (HPI) which is a "tool" for prevention of major incidents that could result in unnecessary costs including accidents and errors.

Babcock & Wilcox Vølund will maintain high standards with continuous training and management involvement to reinforce our primary commitment "Safety First".

Plant design data (per line)		
Process parameters	Guaranteed Values*	Units
Waste capacity	26.7	t/h
Heat value, lower	8.0	MJ/kg
Steam output	82.7	t/h
Steam temperature	400	°C
Steam pressure	43	bar
Thermal input	69.3	MW
Thermal efficiency	86.9	%
TOC, bottom ash	3	%
Feed water temperature	130	°C
Boiler outlet flue gas temp.	190	°C

Flue gas values: Out of boiler	Guaranteed Values*	Units
NO _x **	160	mg/Nm ³
CO***	150	mg/Nm ³
NH ₃ **	10	mg/Nm ³

*All values refer to 11% O₂ dry gas

** Daily

*** 1/2 hour

Babcock & Wilcox Vølund A/S

Falkevej 2 • DK-6705 Esbjerg Ø • Denmark • Tel: +45 76 14 34 00 • Fax: +45 76 14 36 00

We have branch offices in Aarhus and Glostrup/Copenhagen, Denmark.

The information contained herein is provided for general information purposes only and is not intended or to be construed as a warranty, an offer, or any representation of contractual or other legal liability. Babcock & Wilcox Vølund A/S is 100% owned by Babcock & Wilcox Power Generation Group, Inc. in Barberton, Ohio, USA. © 2012 Babcock & Wilcox Vølund A/S. All rights reserved.